

Lod Pendant

Assembly manual

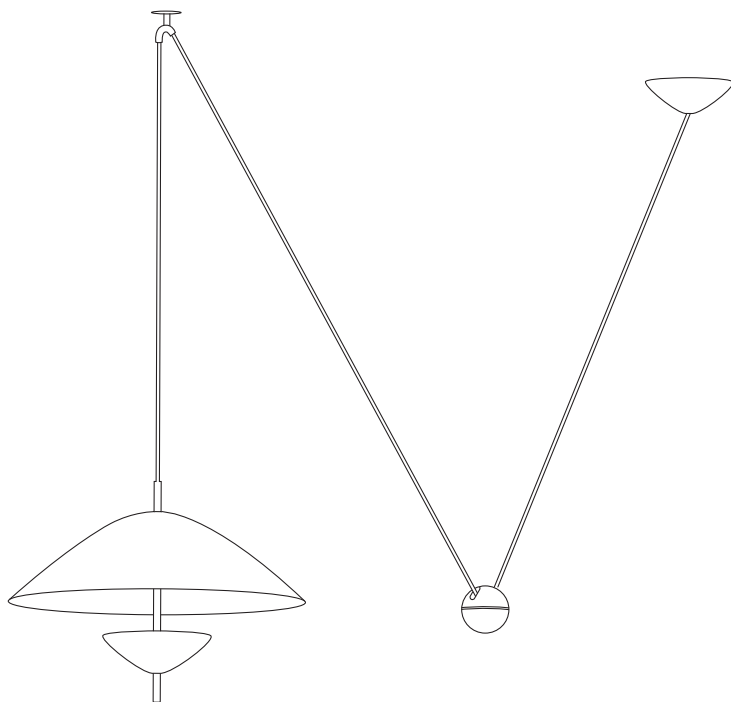

ferm
L I V I N G

General Instructions

PLEASE READ BEFORE INSTALLATION

WARNING:

The safety of this fitting can only be guaranteed if the following instructions are observed during both installation and use. Please retain these instructions safely after installation.

PLEASE OBSERVE THE FOLLOWING GUIDELINES:

- Ensure that the power supply has been switched off prior to installation or removal of the product.
- Never undertake an electrical installation without the proper knowledge or training. If not familiar with electrical wiring, contact a qualified electrician.
- The product may in no way be modified or tampered with. Any modification may compromise safety and make the product itself dangerous to use. ferm LIVING does not accept any responsibility for products that have been modified.
- This product requires the use of a lightbulb that is not included. Please use a lightbulb that has the relevant safety certifications and approvals for your area.
- Any modification must be performed only by qualified personnel to avoid any danger.
- This product is meant for indoor use only.
- This appliance should not be disposed in a domestic trash receptacle and should instead be recycled appropriately.
- Dry locations only.
Pour Emplacements Secs Seulement.
- This product must be installed in accordance with the applicable installation code by a person familiar with the construction and operation of the product and the hazards involved.
Ce produit doit être installé selon le code d'installation pertinent, par une personne qui connaît bien le produit et son fonctionnement ainsi que les risques inhérents.

CLEANING INSTRUCTIONS:

- Use only a soft cloth to clean the product.

MORE INFORMATION:

To access further information such as product overview and material descriptions, please visit our website at www.fermliving.com. If you have any questions or comments, please do not hesitate to contact us at info@fermliving.com.

Technical Specifications

LOD PENDANT:

Voltage:	120V - 60Hz
Dimmable:	No
Certification:	UL, IP20
Socket:	G9 socket base
Recommended light source:	Shielded Tungsten-Halogen or 3x7W SBLED bulb

Box Content

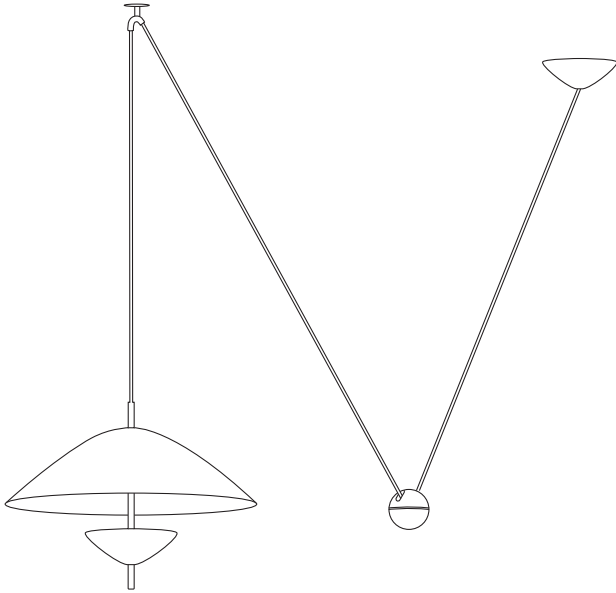

1 x Lamp



3x

Wire connectors

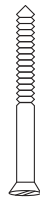

5 x

Screws for ceiling
bracket & canopy



5 x

Rawplugs

Assembly Process

1

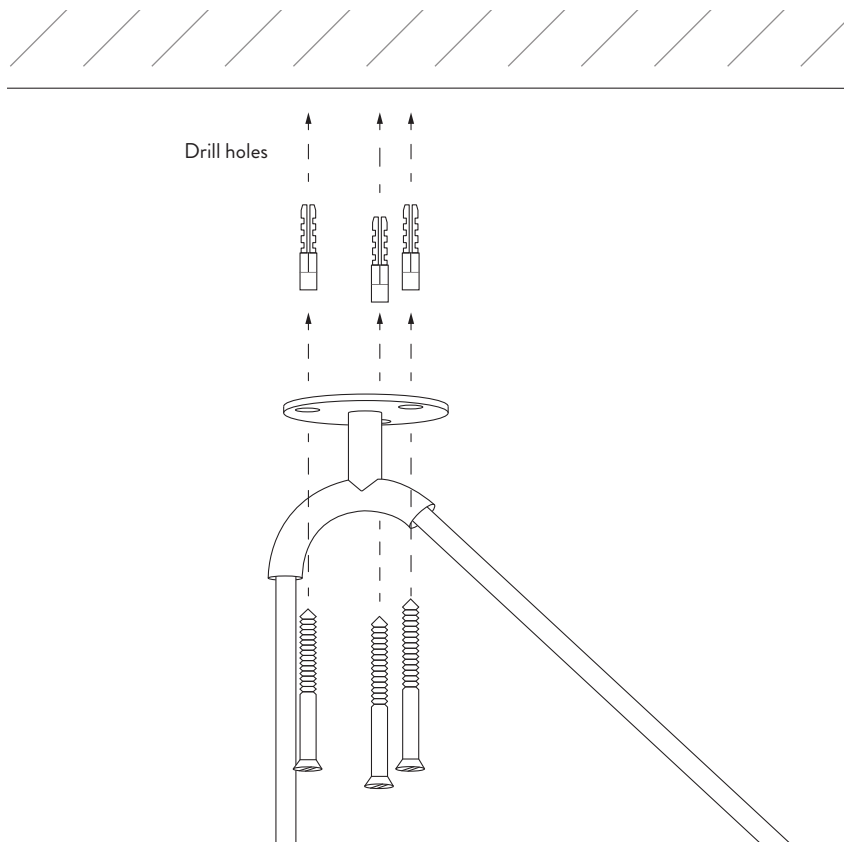

Use the ceiling bracket to mark the three holes' positions. Drill the holes and insert the rawlplugs. Fix the ceiling's bracket thank to the 3 long screws.

Assembly Process

2

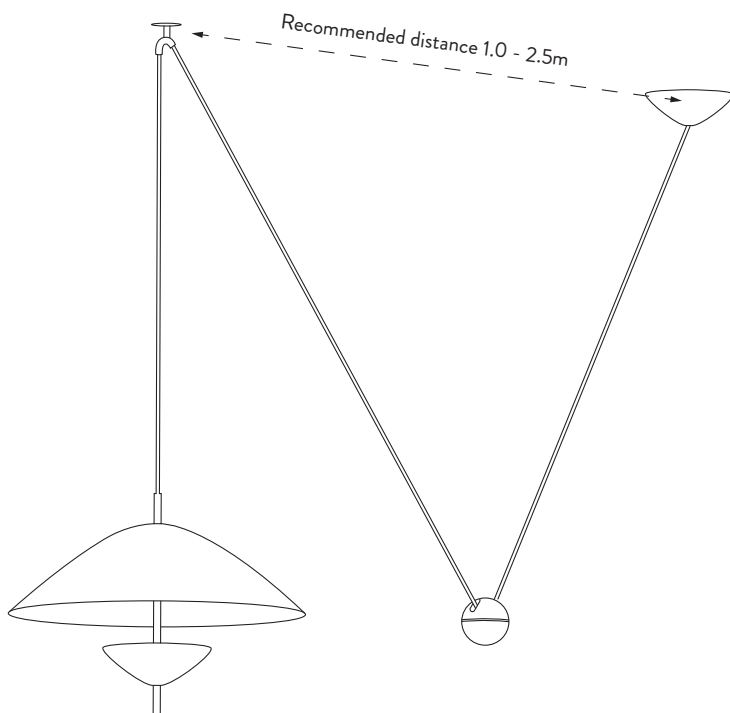

Measure the distance you want between the ceiling bracket and the canopy. Make sure the counterweight sphere is not in the way. Mark the position of the canopy.

Assembly Process

3

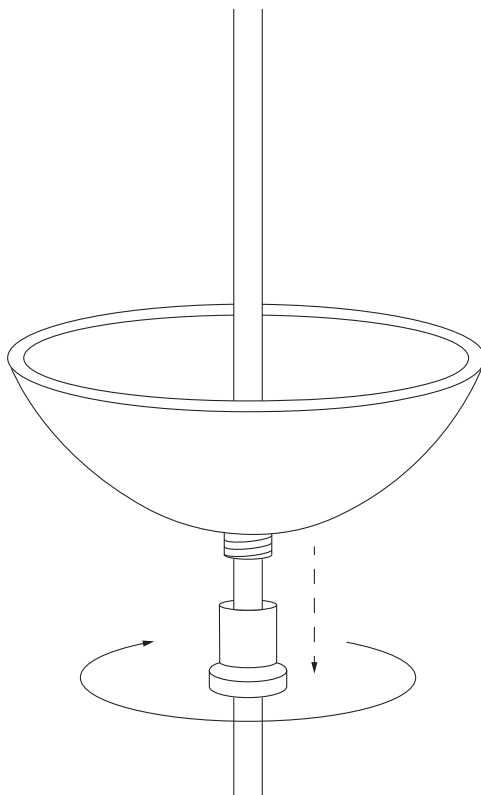

Unscrew the rod at the bottom of the canopy and remove the canopy cover.

Assembly Process

4

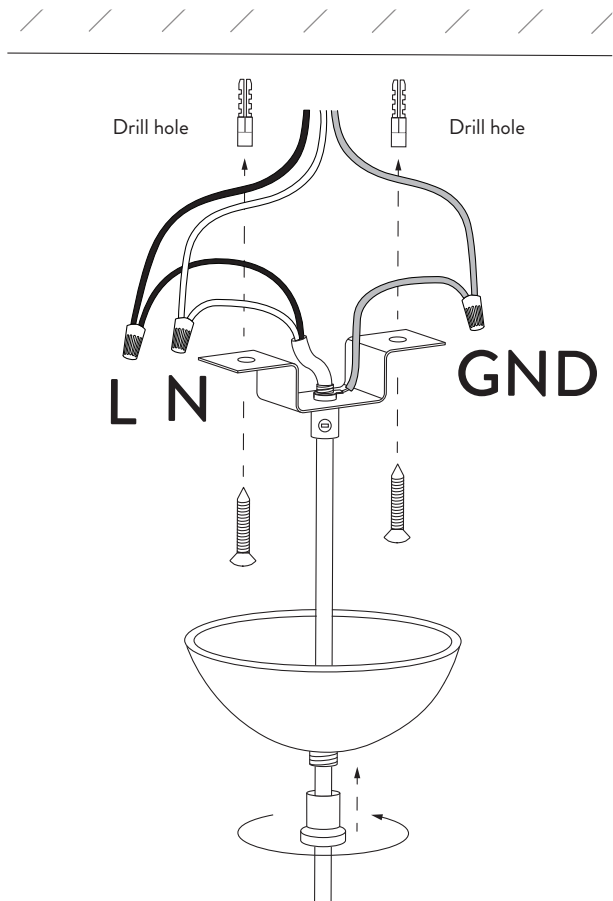

Make connect to the main supply using suitable nuts N. White, L, Black, Green/yellow, GND. Screw the canopy bracket to the junctions box in the ceiling using two screws. Then you close the bottom of the canopy.

Assembly Process

5

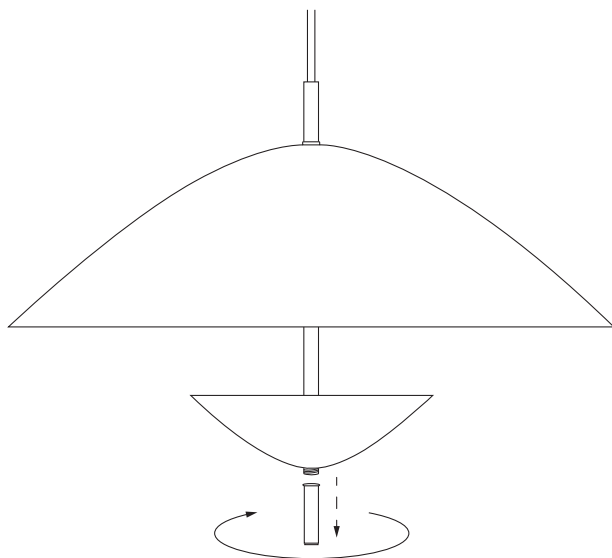

Unscrew the rod at the bottom of the lamp
and remove the cover.

Assembly Process

6

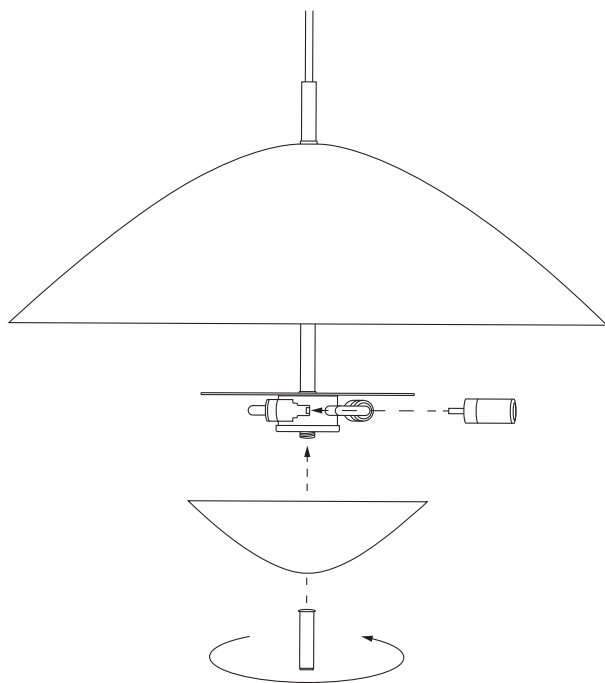

Plug the three G9 bulbs (not included), place the cover back, then, screw the bottom rod.

fermliving.com