

Vuelta Portable Lamp

Assembly Manual

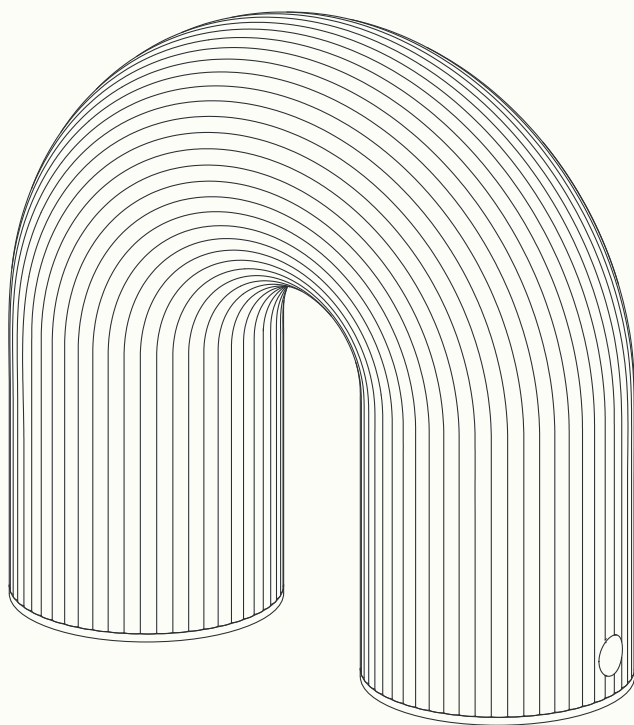

General Instructions

Please read before installation

Warning:

The safety of this product can only be guaranteed if the following instructions are observed during both installation and use. Please retain these instructions safely after installation.

Please observe the following guidelines:

- Ensure that the power supply has been switched off prior to installation or removal of the product.
- Never undertake an electrical installation without the proper knowledge or training. If not familiar with electrical wiring, contact a qualified electrician.
- The product may in no way be modified or tampered with. Any modification may compromise safety and make the product itself dangerous to use. FERM LIVING does not accept any responsibility for products that have been modified.
- The light source contained in this luminaire shall only be replaced by the manufacturer or his service agent or a similar qualified person.
- Please charge the battery before initial use.
- The lamp is not intended for permanent connection to the power supply. Disconnect the charger once the battery is fully charged

Cleaning instructions:

- Use only a soft cloth to clean the product. Dampen the cloth with water and soap or a mild cleanser if needed.

More information:

To access further information such as product overview and material descriptions, please visit our website at www.fermliving.com. If you have any questions or comments, please do not hesitate to contact us at info@fermliving.com.

Technical Specifications

Vuelta Portable Lamp

Wattage: 1W
Voltage: 5V DC
Dimmable: 0% - 10% - 50% - 100% 4 step dimming

LED light:
CCT: 2200K
CRI: >90
Lumen: 65LM
Expected service life: 30.000 Hours

Battery:
Capacity: 2200 mAh
Charging: 5 Hours
Discharging: 8 Hours max power
Battery: 1 Pcs
Battery weight: 35g
Battery type: Litium Iron Battery type 18500
Power: 8.14WH
Life: 80% Capacity after 500 times charging

Cable & Charger requirements:

Cable: 1m length. Mangnetic Pogo-Pin charging, type C on the charger end (not included)
Recommended charger: 5V DC/1A or 5V DC/2A (NOT INCLUDED).
Light source: Non removable dimmable LED
Ingress Protection: IP44
Electrical Protection Class Class III
Certification: ETL, CE, CB, RoHs

Box Content

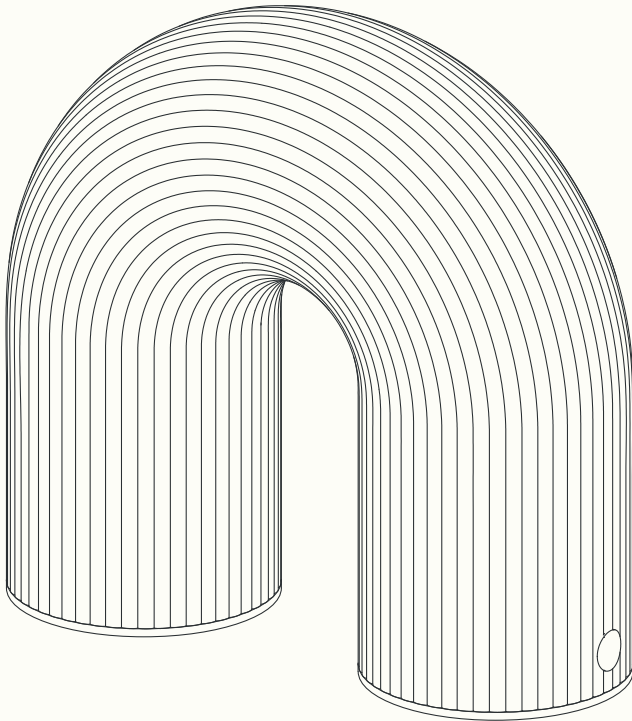

(1x)

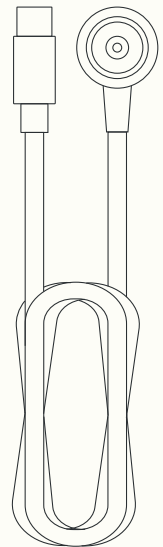

(1x)

01

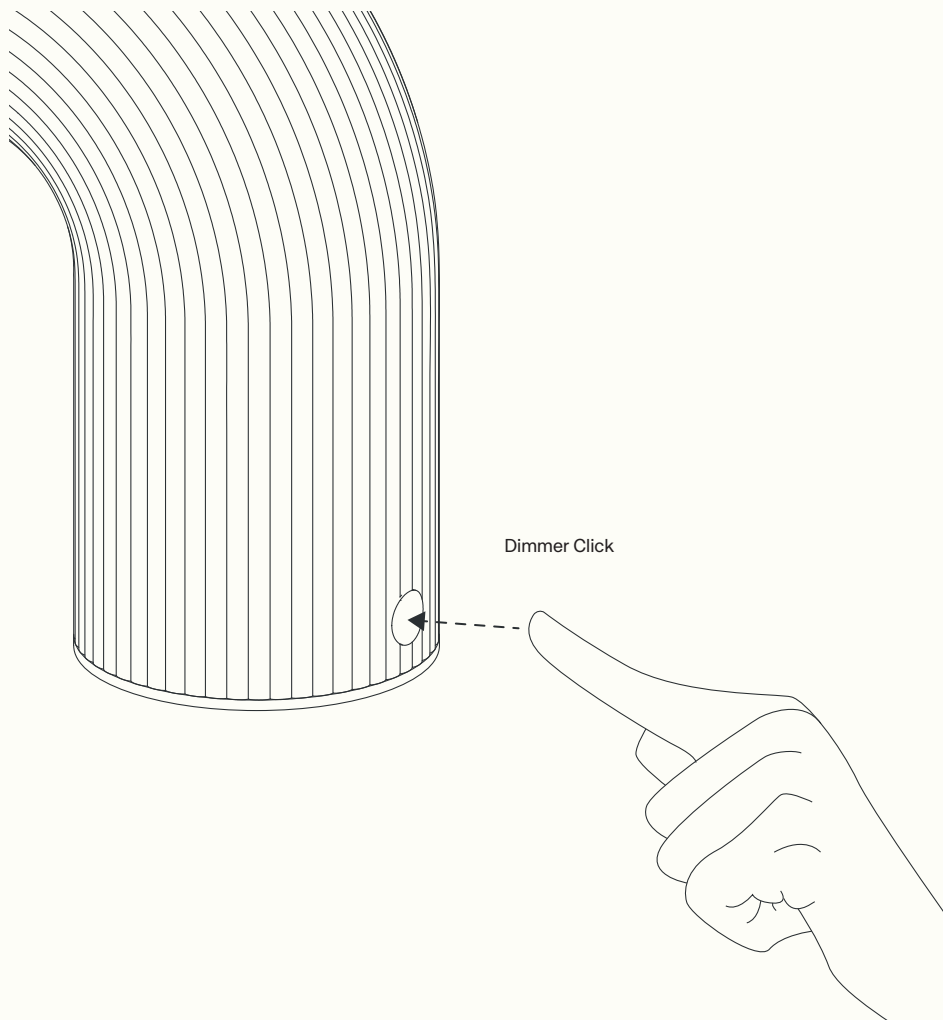

02

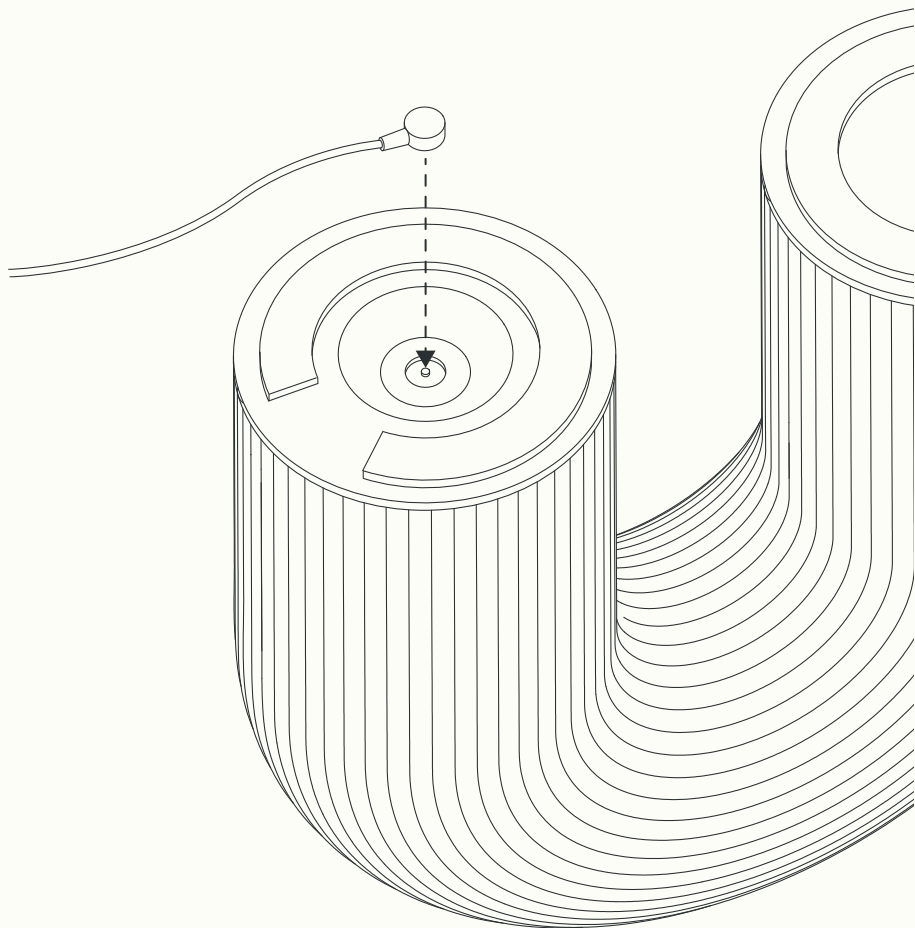

01

Battery Replacement

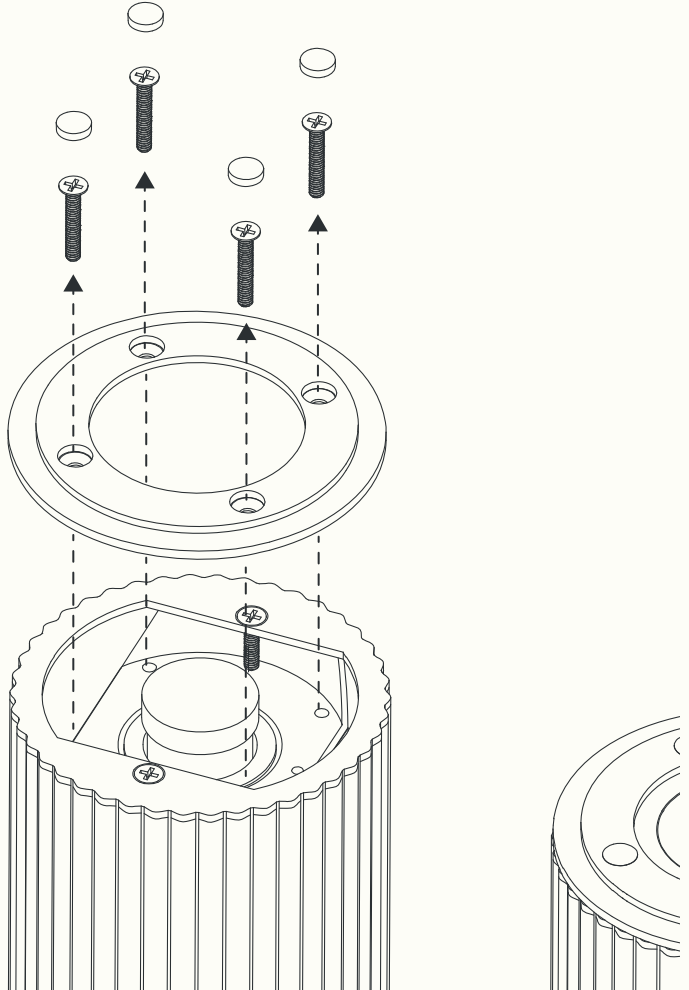

02 Battery Replacement

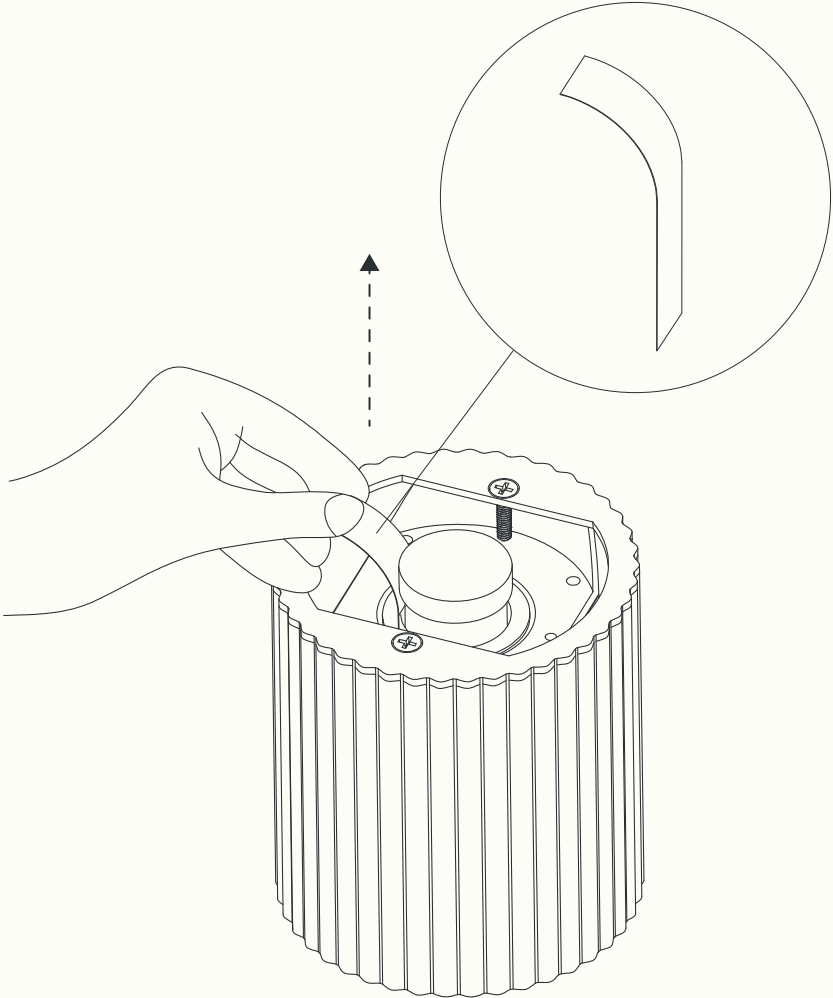

03 Battery Replacement

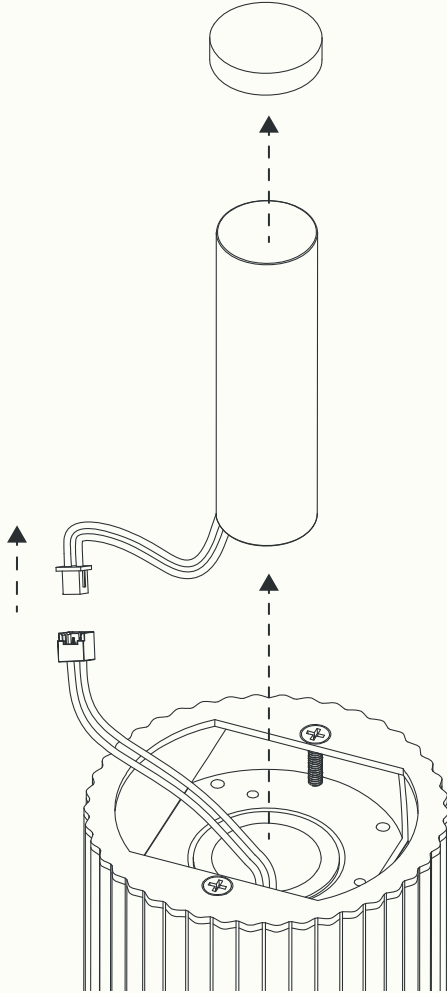

04 Battery Replacement

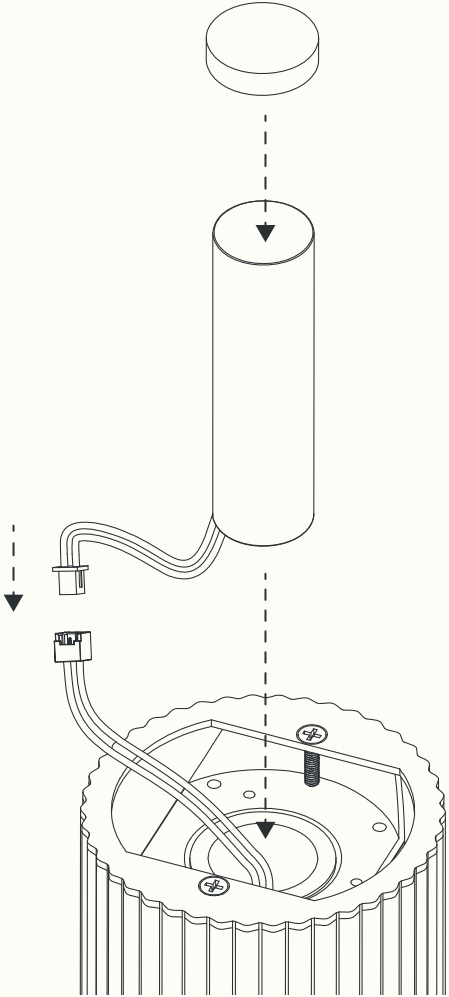

05 Battery Replacement

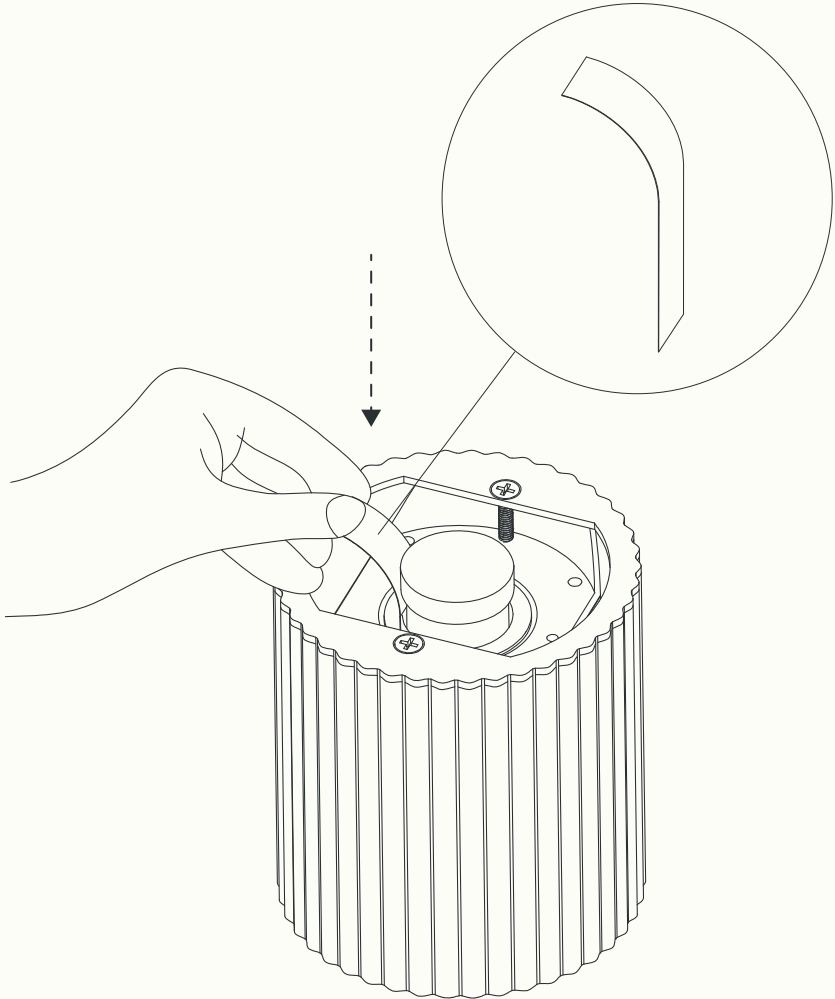

Space to feel comfortably you